

High Pressure Spray Gun

Exploded View

NEW MODEL: Available February 1986. JD9-CT which is tapped at the top of the grip to allow use of a gauge (#302, available separately) to calibrate pressure settings on the gun. Price is the same as JD9-C.

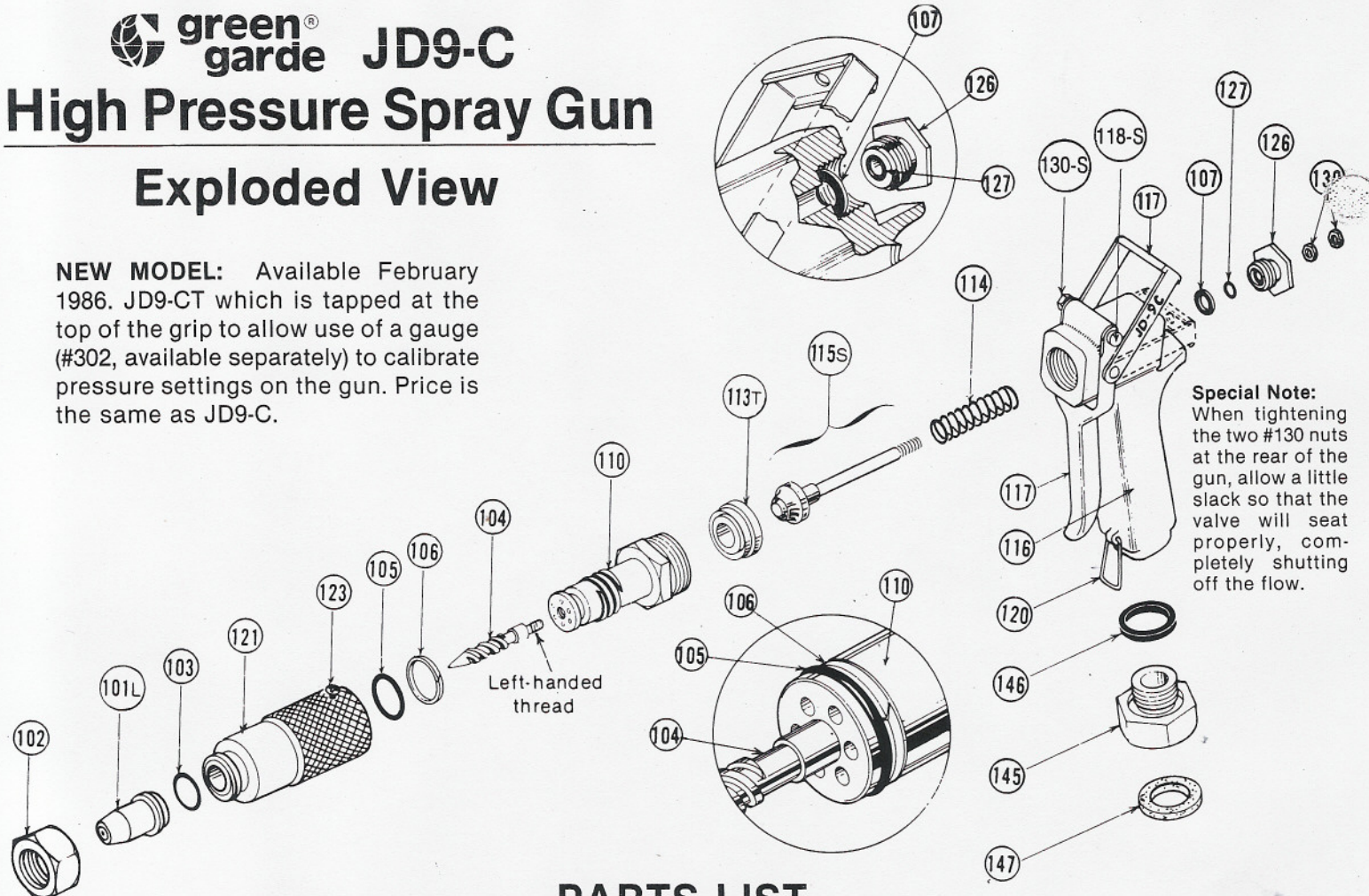

PARTS LIST

| Part No. | Description | Part No. | Description | Part No. | Description |
|----------|-----------------------|----------|------------------------------|----------|------------------------------|
| 101-L | Nozzle tip & retainer | 113-T | Teflon valve seat | 123 | Screw |
| 102 | Cap | 114 | Valve spring | 126 | Gland |
| 103 | O-ring | 115-S | Stainless steel valve | 127 | O-ring P6 |
| 104 | Whirler | 116 | Grip (116T-tapped for gauge) | 130 | Nut M6 (2) |
| 105 | O-ring P18 | 117 | Trigger assembly | 130-S | Nut locking |
| 106 | Back up ring | 118-S | Bolt | 145 | 3/4" Garden hose coupling |
| 107 | Gland packing | 120 | Stopper clip | 146 | Packing |
| 110 | Adjuster body | 121 | Adjuster nut (barrel) | 147 | Garden hose washer |
| | | | | 148 | Plug for gauge (JD9-CT only) |

101-C Repair Kit (includes 1 each #103, 105, 106, 107 and 127)

SPRAY GUN TIPS

| | | |
|--------|-------------|---|
| 101-SX | EXTRA SMALL | - Flow Rate of 0.3 to 1 GPM |
| 101-S | SMALL | - Flow Rate of 1.0 to 3 GPM |
| 101-M | MEDIUM | - Flow Rate of 2.0 to 5 GPM |
| 101-L | LARGE | - Flow Rate of 3.0 to 8 GPM (Supplied With Gun) |
| 101-LX | EXTRA LARGE | - Flow Rate of 10 to 19 GPM |

*Flow rates indicated are approximate, depending upon pressure at the gun. Tips are chrome-plated with hardened steel apertures for longer wear.

To Install Tip: Unscrew #102 Cap, remove #103 O-Ring from old tip and place on new tip, install new tip and replace cap.

ACCESSORIES

| | |
|---------|--|
| 101-FAP | FLOODING NOZZLE - Flow Rate of 4 to 5 GPM (Poly body w/aluminum screen) |
| 201-RF | ROOTFEEDER - Available with 2, 3 and 4 hole tips (see Rootfeeder catalog sheet) |
| 301 | ADAPTER - For fitting a variety of spray tips, wands and extensions |
| 302 | GAUGE - For JD9-CT Tapped Gun <i>only</i> (to calibrate pressure setting at gun) |
| F-601-4 | FLOODING NOZZLE - Flow Rate of 4 GPM (old No. 101-FB) |
| F-602-2 | FLOODING NOZZLE - Flow Rate of 2 GPM (old No. 101-FB2) |
| F-603-5 | FLOODING NOZZLE - Flow Rate of 4 to 5 GPM |
| F-604-2 | *FLOODING NOZZLE - Flow Rate of 2 GPM ("Baseball" hole pattern) |
| F-605-1 | FLOODING NOZZLE - Flow Rate of 1 GPM (Extra-low volume) |

*Flow rates indicated for flooding nozzles are approximate, depending upon pressure.

All Flooding nozzles *except* #101-FAP, are Brass Body with Stainless Steel Screen.
To Install Flooding Nozzle: Remove cap, tip and o-ring from gun; screw nozzle bushing onto #121 barrel.