

See Detail A

Detail (A)

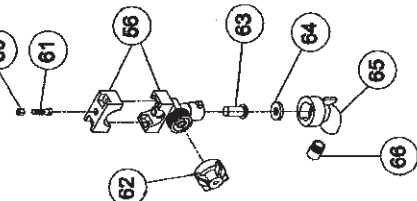

**SDI Inoculation Sprayer
 Model IS30**

SDI Inoculation Sprayer Model No. IS30

Item Number	Part Number	Description	Qty
1	15-810	Tank, 10 Gal	1
2	15-830	Tank, 30 Gal	1
3	15-815	Wire Rack, 10 Gal	1
4	60-522	Float Valve Gray, Poly	1
5	60-523	Float Valve Stem	1
6	60-503	Float Ball 5"	1
7	16-117	Tank Fitting 1" DT 1-1/2" Hole, Poly	1
8	51-601SS	Close Nipple 1" SST	1
9	60-204	Gate Valve 1"	1
10	52-122	Elbow Adapter 1 MPT x 1-1/4" HB, Poly	1
11	24-120	Hose Clamp #20	5
12	11-9500	Tank Stand/Pole Support	1
13	52-120	Elbow Adapter 1 MPT x 1" HB Poly	1
14	24-106	Hose Clamp #6	2
15	53-095	Adapter 1/2 FPT x 1/2 HB Straight	1
16	50-210	Street Elbow 1/4" x 90° Brass	1
17	16-112L	Tank Flange 1/4" Brass	1
18	RM1214P	Reducing Nipple 1/2 MPT x 1/4 MPT, Poly	1
19	50-211	Elbow 1/4" x 90° Brass	1
20	60-220	Ball Valve 1/2 PVC	1
21	50-460B	Bushing 1/2 x 1/4" Brass	1
22	79-018	Flowmeter Panel Mount	1
23	19-055	Centrifugal Pump W/Motor	1
24	21-932	Suction Hose 1-1/4 ID 100 PSI, Per Foot	Specify
25	60-682	Lever Handle 1/8" Ball Valve	1
26	51-240	Close Nipple 1/8" SST	1
27	52-126	Elbow Adapter 1-1/4 MPT x 1-1/4" HB, Poly	1
28	53-809	Street Elbow 1" x 90°, PVC	1
29	83-500C	Hose 1/2" 200 PSI, Clear Braided Vinyl, Per Foot	Specify
30	53-912	Close Nipple 1" PVC	2
31	53-826	Tee 1", Poly	2
32	53-801	Bushing 1 x 3/4", Poly	1
33	64-950	Injector	1
34	53-435	Adapter 1 MPT x 1" HB, Poly	3
35	24-116	Hose Clamp #16	4
36	24-110	Hose Clamp #10	13
37	52-119	Elbow Adapter 1 MPT x 3/4" HB, Poly	1
38	21-930	Hose 3/4" ID 200 PSI, Per Foot	Specify
39	53-134	Adapter 3/4 MPT x 3/4" HB, Poly	3
40	60-203	Gate Valve 3/4"	1
41	53-909	Close Nipple 3/4" PVC	2
42	52-280	Elbow 3/4" x 90° TxT, PVC	1
43	21-938	Hose 1" ID, 200 PSI, Per Foot	Specify

SDI Inoculation Sprayer Model No. IS30

Item Number	Part Number	Description	Qty
44	60-355	Ball Check Valve 1" True Union	1
45	47-210	U-Bolt 3/8 NC x 3 x 2-3/4"	2
46	24-132	Hose Clamp #32	1
47	48-302	Detent Pin 5/16 x 2-1/2"	2
48	11-9505	Telescoping Pole Lock 2-1/2" Long	1
49	24-124	Hose Clamp #24	1
50	11-9506	Telescoping Pole Lock 68" Long	1
51	11-9507	Telescoping Pole Lock 45" Long	1
52	11-9501	Pole Assembly 16'	1
53	11-9502	Boom/Inoculation Sprayer	1
54	64-437	Hose Shank 500 Dbl 3/4 HB x Blank, Dry Boom	2
55	64-435	Hose Shank 750 Dbl 3/4 HB x 3/4 HB Dry Boom	4
56	64-411	Single Nozzle Body W/Check Valve	6
57	53-825	Tee 3/4" PVC	1
58	52-114	Elbow Adapter 3/4 MPT x 1" HB, Poly	1
59	72-040	Electric Timer	1
60	41-512	Lock Nut Nylon 5/16" NC SST	6
61	31-504	Hex Bolt 5/16 x 1-1/4" SST	6
62	64-415/02	End Cap Check Valve 02 PSI	6
63	64-403	Strainer Screen, Nylon	6
64	64-404	Rubber Washer	6
65	64-340	Quick Adapter 90 x 1/4 Thread	6
66	64-348	Tip Solid Stream Nozzle, SST	6

PL12/10jj