

**SDI Pit Stop, Model No.
PS1000-50K6M**

PI223/0101jj

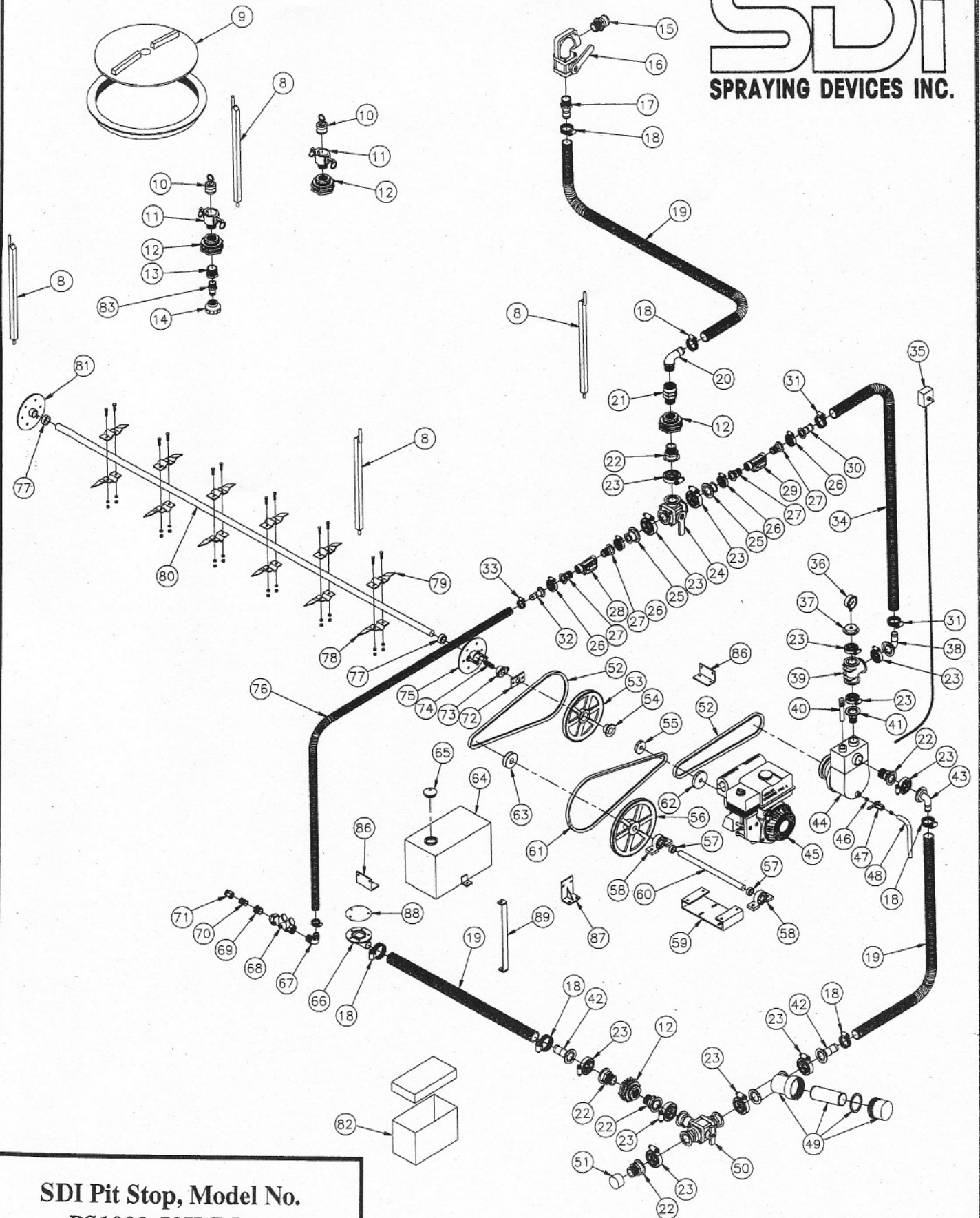

**SDI Pit Stop, Model No.
PS1000-50K6M**

PI223/0101jj

SDI Pit Stop - Model No. PS1000-50K6M

Item Number	Part Number	Description	QTY
1	15-900WH	Tank, 1000 Gallon, White	1
2	15-930WH	Canopy, 1000 Gallon, White	1
3	15-916	Belt Guard	1
4	11-940	Canopy Support, 1000 Gallon	1
5	10-915	Frame	1
6	10-1053	Tank Saddle	2
7	11-941	Step	1
8	10-901	Tank Straps	4
9	15-020	Lid Assembly, 20" Threaded	1
10	52-681	Q.C. Plug 1-1/2"	2
11	52-679	Adapter 1-1/2" FQC x 1-1/2" MPT	2
12	52-670	Bulkhead Fitting 1-1/2" Poly	4
13	52-672	Adapter 1-1/2" MPT x 1-1/4" FPT	1
14	64-683	Teflon Tank Rinse Nozzle	1
15	52-680	Adapter 1-1/2" MQC x 1-1/2" MPT	1
16	52-682	Fill Valve 1-1/2" FPT x 1-1/2" FPT	1
17	52-678	Adapter 1-1/2" MPT x 1-1/2" HB	1
18	24-124	Hose Clamp #24	6
19	83-150	Hose, 1-1/2" ID, 150 PSI, Per Foot	Specify
20	52-671	Elbow Adapter 1-1/2" MPT x 1-1/2" HB	1
21	52-674	Swivel 1-1/2" MPT x 1-1/2" FPT	1
22	52-659	2" Std Port Flange x 1-1/2" MPT	4
23	52-653	Worm Screw Clamp, 200 Series	12
24	52-661	2" Std Port Flange x Top Load	1
25	52-669	2" Std Port Flange x 1" Std Port Flange	2
26	52-652	Worm Screw Clamp, 1" Series	4
27	52-657	1" Std Port Flange x 1" MPT	4
28	79-015	1" FPT Water Only Flow Meter	1
29	79-016	Chemical Flow Meter 1" FPT	1
30	52-666	1" Std Port Flange x 1-1/4" HB	1
31	24-120	Hose Clamp #20	2
32	52-665	1" Std Port Flange x 1" HB	1
33	24-116	Hose Clamp #16	2
34	83-125	Hose 1-1/4" ID, 150 PSI, Per Foot	Specify
35	72-120/091	Switch and Switch Box	1
36	27-100	Pressure Gauge, 0-100 PSI	1
37	52-656	2" Std Port Flange Plug W/1/4" FPT	1
38	52-664	2" Std Port Flange x 1-1/4" HB Elbow	1
39	52-668	2" Std Port Flange x Tee	1
40	72-011	Corrosion Inhibitor Plug 3/4"	1
41	52-658	2" Std Port Flange x 1-1/4" MPT	1
42	52-667	2" Std Port Flange x 1-1/2" HB	2
43	52-663	2" Std Port Flange x 1-1/2" HB Elbow	1
44	19-9253C-C-SP	Pump, 136 GPM, 180 PSI W/Clutch	1
45	20-107E	Engine, 6 HP Electric Start	1
46	51-240	Close Nipple 1/8", SS	2
47	60-682	Lever Handle 1/8" Ball Valve	1
48	16-922	Clear Tubing 3/8" ID, Per Inch	Specify
49	52-660	2" Std Port Flange x Strainer	1
50	52-662	2" Std Port Flange x Side Load	1

SDI Pit Stop - Model No. PS1000-50K6M

Item Number	Part Number	Description	QTY
51	52-675	Pipe Cap 1-1/2" Poly	1
52	67-440	Belt, 5L440	2
53	66-112	Pulley 9.75 OD x H Bushing	1
54	66-083	Bushing H x 1-3/16" Bore	1
55	66-171	Pulley BK70 x 3/4" Bore	1
56	66-124	Pulley AK124 x 1" Bore	1
57	16-283	Shaft Collar 1" SST	2
58	68-110	Pillow Block Bearing 1"	2
59	11-211	Bearing Mount/Jack Shaft	1
60	63-217	Jack Shaft 1 x 17"	1
61	67-590	Belt 4L600	1
62	66-127	Pulley AK27 x 3/4" Bore	1
63	66-136	Pulley BS32 X 1" Bore	1
64	11-944	Fuel Tank	1
65	72-303	Fuel Cap Assembly	1
66	17-131	Suction Flange 1-1/2"	1
67	NPN	Adapter Elbow 1" MPT x 1" HB	1
68	60-350	Double Check Valve 1" FPT x 1" FPT	1
69	50-663SS	Bushing 1" MPT x 3/4" FPT	1
70	51-501SS	Close Nipple 3/4" SST	1
71	55-101	Adapter 3/4" MTP x 3/4" FGHT	1
72	11-105	Packing Nut Plate	1
73	16-277	Packing Nut 1-3/16" Nylon	1
74	16-950	Teflon Packing, Per Inch	Specify
75	16-276	Packing Gland 1-3/16" Nylon	1
76	83-100	Hose 1" ID, 150 PSI, Per Foot	Specify
77	16-284	Shaft Collar 1-3/16", SST	2
78	16-267	Right Agitator Paddle 1-3/16"	6
79	16-266	Left Agitator Paddle 1-3/16"	6
80	16-1051	Agitator Shaft 1-3/16" x 101", SST	1
81	16-292	Rear Bearing 1-3/16", Nylon	1
82	72-600	Battery Box	1
83	52-676	Adapter 1-1/4" MPT x 3/4" MPT	1
84	64-034	Vinyl Trim, White, Per Foot	Specify
85	64-033	Vinyl Trim, Black, Per Foot	Specify
86	11-942	Side Belt Guard Brackets	2
87	11-670	Front Belt Guard Bracket	1
88	11-101	Vortex Baffle	1
89	11-943	Fuel Tank Support	1