



**Spraying Devices, Inc.**  
Manufacturer of Quality Power Sprayers  
P. O. Box 3107 • Visalia, CA. • USA  
Tel: 559-734-5555 • Fax: 559-734-5591  
email: [sales@sprayingdevices.com](mailto:sales@sprayingdevices.com)  
[www.sprayingdevices.com](http://www.sprayingdevices.com)



Spot Sprayers

**Introduction:** Your sprayer has been manufactured to provide the maximum in dependable efficient use. Proper operation and maintenance will ensure long satisfactory service. Study this manual carefully to become familiar with the operation and maintenance instructions.

Keep your manual in a safe, convenient place for future reference. Always mention the model and part number in any correspondence. To insure correct parts be sure to use the part number and description when ordering.

**Assembly:** Check inside tank for any foreign objects. Install gun clips using screws. Attach hose to the discharge port of the diaphragm pump using plastic clamp provided. Install drain cap and washer. Install tank lid tether.

**Operation:** Operating power is obtained directly from a 12 VDC source. Be sure to connect the red to the positive (+) source and attach the black to the negative (-) source.

IMPORTANT: Before spraying chemicals, fill the tank half full of plain water to allow familiarization with the sprayer and to prevent waste of expensive chemicals.

**Sprayer Maintenance:** A sprayer is a carefully designed and built machine that should provide many years of reliable service if properly cared for, the main rule in caring for any sprayer is KEEP IT CLEAN. Neglect costs dollars in repairs, wasted spray material and premature replacement of the sprayer.

**Cleaning and Storage:** Most spray materials are highly corrosive. The most important aspect of long dependable service from the sprayer is a thorough cleaning immediately following each use. In addition, the residue of one type of chemical could cause an undesirable effect when a different chemical is used for a different purpose.

The most effective cleaning method is to pump several rinses of clean water through the tank, pump, hoses, boom, spray gun, etc. A neutralizing agent such as a solution of Nutra-Sol, a detergent or household ammonia as recommended by the chemical manufacturer can assist in removal of a persistent chemical. When the system is thoroughly cleaned, drain the tank, suction line, pump, hoses, etc.

The following steps should be followed for the maintenance and storage of your sprayer.

1. Wash and flush out sprayer after completion of each phase of your program. Flush out sprayer when changing chemicals if there is a possibility of the chemicals being incompatible. Use of a detergent is advisable if the chemical manufacturer does not make specific cleaning recommendations. Flush system completely including nozzles. Never use metal objects to open clogged nozzles.
2. Clean sprayer thoroughly before storing at the end of the spraying season. Permanent type anti-freeze added to the final rinse will leave a rust inhibiting film in parts of the sprayer.

# 15/25/40/60 Gallon Spot Sprayer

## Parts List

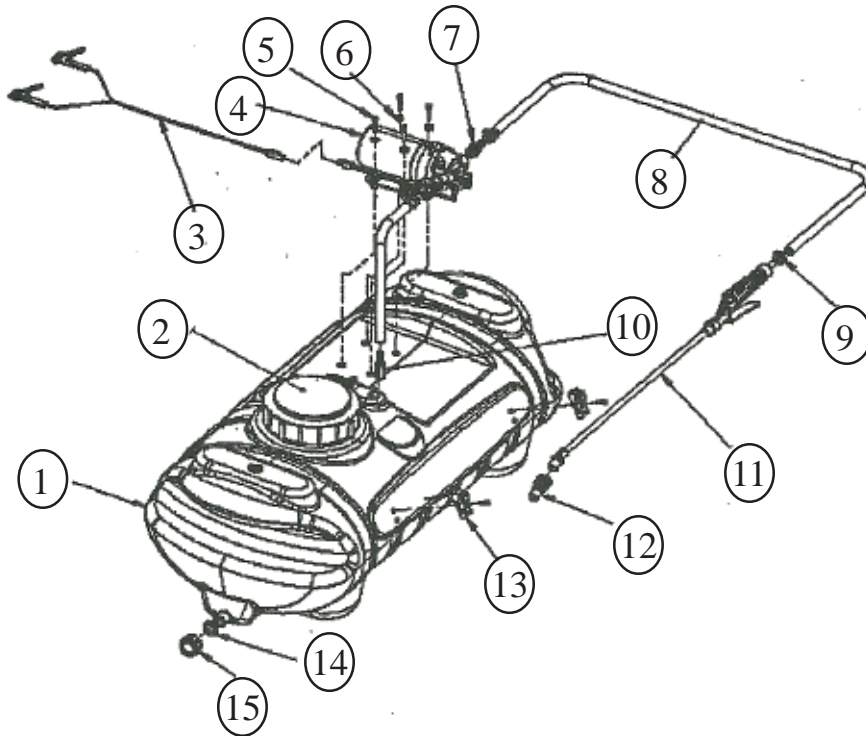

<u>Item No.</u>	<u>Part No.</u>	<u>Description</u>	<u>Qty</u>
1	33-103231	15 Gal Tank	1
	33-103230	25 Gal Tank	1
	33-103245	40 Gal Tank	1
	33-103246	60 Gal Tank	1
2	TL-6B	Tank Lid	1
3	33-103234	Wire Harness SS	1
4	33-103232	1.8 GPM Shurflo Pump	1
5	33-103126	Machine Screw 10-24 x 5/8, 15 Gal	4
	33-103127	Machine Screw 10-24 x 1, 1.8 GPM Pump	4
6	33-103131	Washer #10	4
7	A38	Fitting 3/8 MNPT x 3/8" HB	2
8	3204-1407	Rubber Hose 3/8"	15 Ft.
9	SHC-F	Hose Clamp	3
10	33-103121	Inlet Strainer	1
11	SG-4507F	Wand with Filter	1
12	SG-45ASSY-18	Nozzle Assembly	1
13	GC-100-KIT	Gun Clips, Pair	1
14	W406-V	Garden Hose Washer	1
15	3N34	Garden Hose Cap	1
	3204-1407	Rubber Hose 3/8 x 18" Inlet to pump	18"

## Warranty

Products sold shall be warranted from defects in workmanship and material when used within the service and scope for which they were designed for a period of one year from date of purchase.

Contact your distributor/dealer for replacement parts or warranty work.  
Please have your original sales receipt or other proof of purchase date when requesting any warranty work.

