

2

Installing the Hose-Reel Mount

Parts needed for this procedure:

1	Hose-reel mount
1	Tube mount
1	Hex-head screw (1/2 x 2-1/4 inches)
1	Locknut (1/2 inch)
1	Clevis pin (1/2 x 2 inches)
1	Hairpin cotter

Installing the Hose-Reel Mount to the Front of the Machine

For Machines with the Front Hitch Kit with a Brush Guard Installed

1. Insert the tube mount into the hose-reel mount until the holes in the tube mount align with the farthest holes in the hose-reel mount (Figure 1).

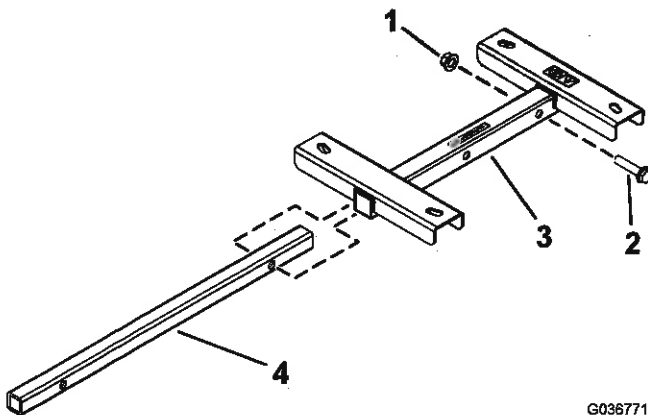

Figure 1

1. Locknut (1/2 inch)
2. Hex-head screw (1/2 x 2-1/4 inches)
3. Hose-reel mount
4. Tube mount

2. Secure the tube mount to the hose-reel mount with the hex-head screw (1/2 x 2-1/4 inches) and the locknut (1/2 inch) as shown in Figure 1.
3. Loosen the "T" handle on the front hitch attachment (Figure 2).

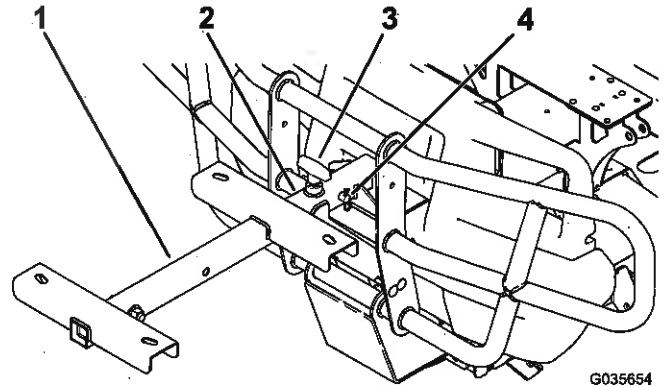

Figure 2

1. Tube mount
 2. Front hitch attachment
 3. "T" handle
 4. Clevis pin (1/2 x 2 inches) and hairpin cotter
4. Insert the tube mount into the front hitch attachment and secure it with the clevis pin (1/2 x 2 inches) and hairpin cotter (Figure 2).
 5. Tighten the "T" handle on the front hitch attachment (Figure 2).

Installing the Hose-Reel Mount to the Front of the Machine

For Machines with the Front Hitch Kit without a Brush Guard Installed

1. Insert the tube mount into the hose-reel mount until the holes in the tube mount align with the farthest holes in the hose-reel mount (Figure 1).
2. Secure the tube mount to the hose-reel mount with the hex-head screw (1/2 x 2-1/4 inches) and the locknut (1/2 inch) as shown in Figure 1.
3. Loosen the "T" handle on the front hitch attachment (Figure 3).

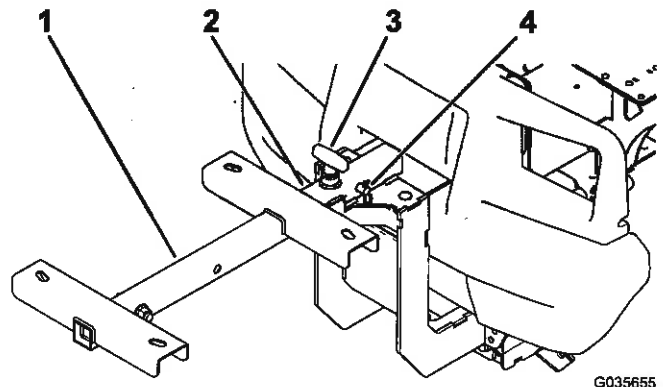

Figure 3

1. Tube mount
2. Front hitch attachment
3. "T" handle
4. Clevis pin (1/2 x 2 inches) and hairpin cotter

4. Insert the tube mount into the front hitch attachment and secure it with the clevis pin (1/2 x 2 inches) and hairpin cotter (Figure 3).
5. Tighten the "T" handle on the front hitch attachment (Figure 3).

Installing the Hose-Reel Mount to the Rear of the Machine

1. Insert the tube mount into the hose-reel mount until the holes in the tube mount align with the front holes in the hose-reel mount (Figure 4).

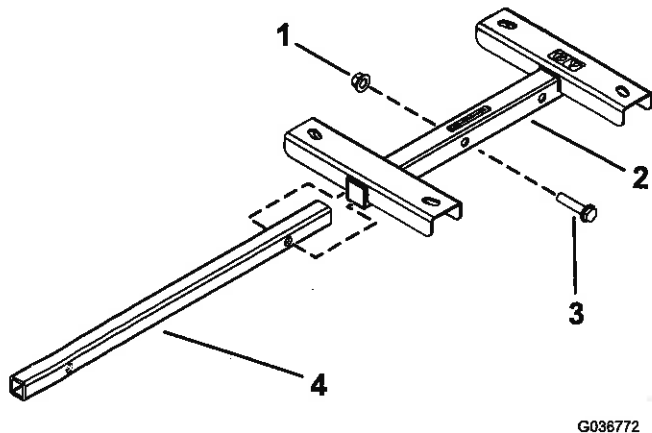

Figure 4

- | | |
|-----------------------|--|
| 1. Locknut (1/2 inch) | 3. Hex-head screw (1/2 x 2-1/4 inches) |
| 2. Hose-reel mount | 4. Tube mount |

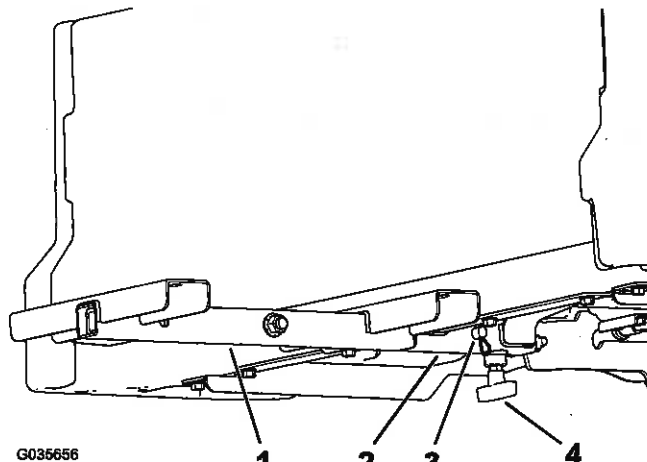

Figure 5

- | | |
|-----------------------|---|
| 1. Tube mount | 3. Clevis pin (1/2 x 2 inches) and hairpin cotter |
| 2. Cargo bed receiver | 4. "T" handle |

4. Insert the tube mount into the cargo bed receiver and secure it with the clevis pin (1/2 x 2 inches) and hairpin cotter (Figure 5).
5. Tighten the "T" handle on the cargo bed receiver (Figure 5).

2. Secure the tube mount to the hose-reel mount with the hex-head screw (1/2 x 2-1/4 inches) and the locknut (1/2 inch) as shown in Figure 4.
3. Loosen the "T" handle on the cargo bed receiver (Figure 5).