

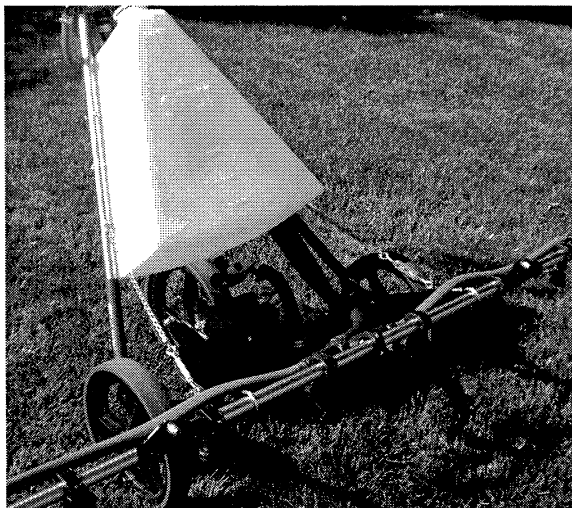

# Product/Service

Spraying Devices  
Inc.

## Turf Walker SC Assembly Instructions



Congratulations on your purchase of the SDI **Turf Walker SC** self contained walking spray boom! We know you'll be delighted with your purchase and it will serve you well for many years.

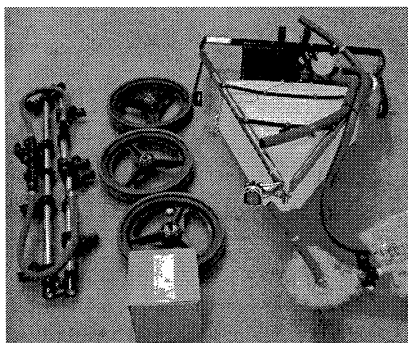

After opening the box, remove the packing material and inspect for damage that might have occurred during shipping. You should have all the parts shown at left.

1) Move the frame tubing (#17 on drawing) to the upright position and insert the 3/8 x 1 1/4" bolt into the lower hole on each side.

2) Install the wheels on the axle (#46) using the supplied bolts attaching the wheel with longest bolt in the center position. Be sure the magnet faces the speedometer pickup on the axle.

3) Attach the spray gun to the top of the frame tubing using the existing 3/8 x 1 1/4" bolt.

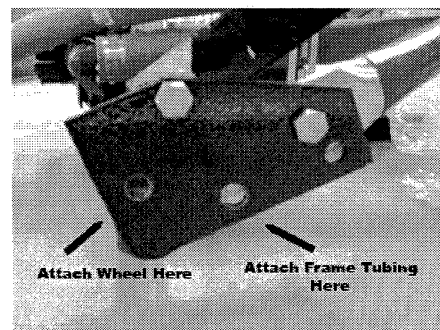

Spraying Devices Inc.

PO Box 3107  
Visalia, CA 93278-3107

Phone: 559-734-5555  
Fax: 559-734-5591  
sales@sprayingdevices.com  
www.sprayingdevices.com

4) Move the boom mounting brackets (29&30) into the forward position.

5) Attach the spray boom to the boom mounting brackets using the turnbuckles to adjust the height of the spray boom. The spray tips should be 10 inches above the ground. If you are unable to achieve the correct height you may need to remove chain links as needed.

6) Attach the hose to the spray gun, return hose to tank and hose to the spray boom.

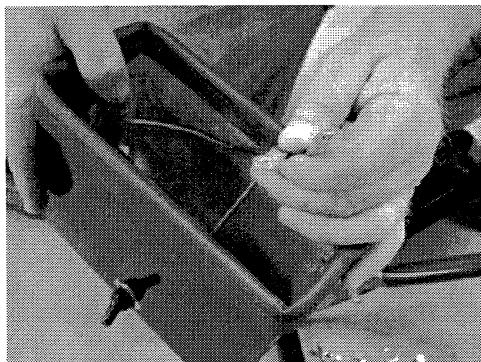
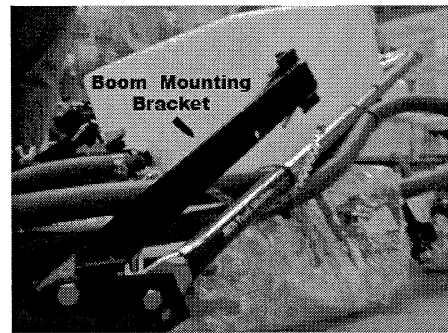

7) Remove the battery cover.

8) Install the battery using the supplied clamp and bolts to secure it to the axle. Connect the spade fittings inside the battery cover to the corresponding connections on the battery and feed the pump connector/recharging plug through the oval hole on the side of the cover.

9) Connect the charger and charge the battery for 8 hours on the initial charge. Confirm that the toggle switch is in the ON position for battery charging.

## Using Your Turf Walker SC

- After charging the battery for your initial test, first fill the tank with water.
- Confirm that the 3 way valve on the bottom of the tank is in the open position (handle is vertical).
- Start the pump by flipping the toggle switch to ON. Generally the pump will start for a few seconds then stop.
- Fold down the boom in preparation for spraying.
- Move to the rear of the Turf Walker SC, grip the handle of the spray gun and squeeze the handle to start the spray. It may take a few seconds for the pump to prime and fill the hoses with water.
- When the spray starts to flow from the boom adjust your spray pressure by rotating the lever on the ball valve located by the spray gun. This valve also controls the return of material to the tank.
- We recommend premixing your spray solutions prior to adding them to the tank and not using the tank to mix your spray materials.

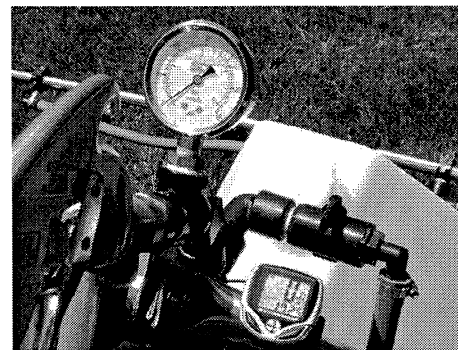

We are confident that following the above instructions for assembling and using your sprayer will get you off to a good start. If you have questions on assembly or the proper use of your equipment please contact your dealer.

**Thank you for buying a SDI sprayer!**

# WBSC6 Assembly Illustration

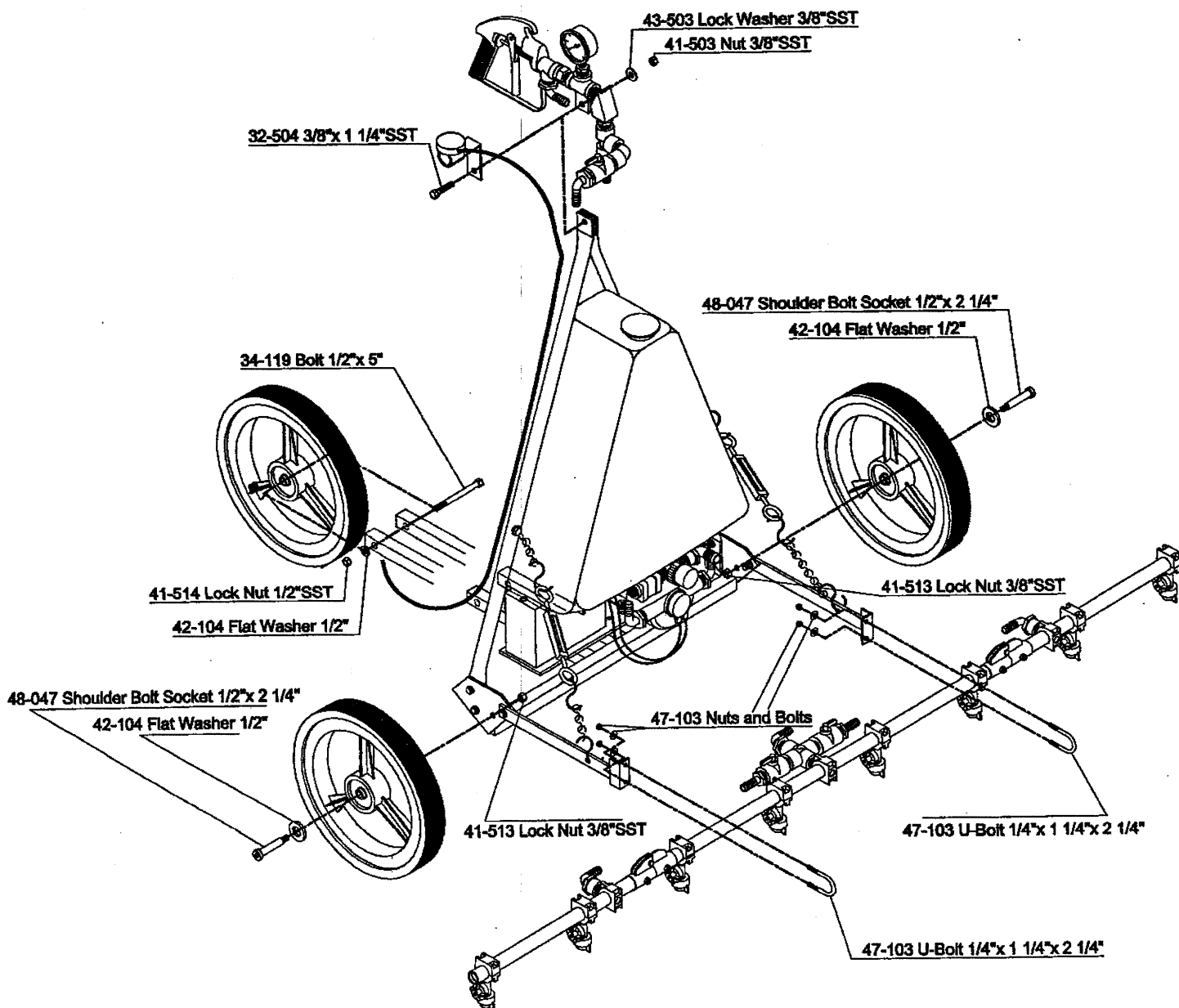

5/10/11/jj

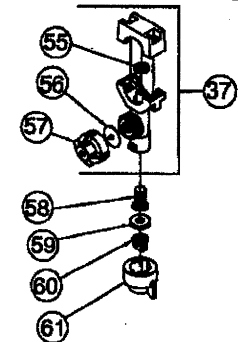
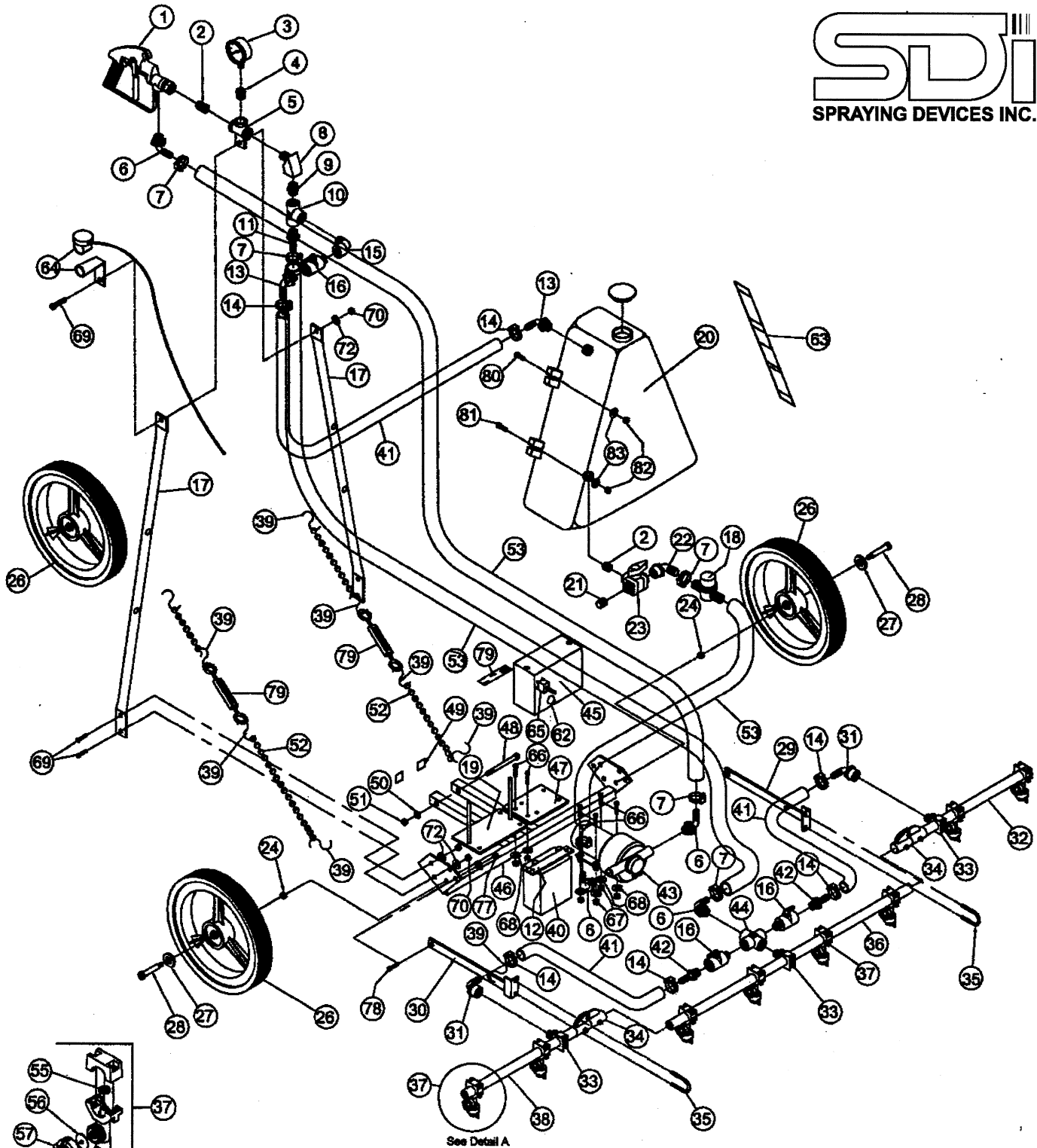

Detail A

**SDI Self-Contained Turf  
Walker, Model WBSC6**

PI386/711jj/Rev 1

## SDI Self-Contained Turf Walker Spray Boom

Item Number	Part Number	Description	Qty
	<b>WBSC6</b>	<b>Self Contained Turf Walker Spray Boom</b>	
1	64-043	Gunjet Spray Gun	1
2	53-901	Close Nipple 1/2 In NPT PVC	2
3	27-060	Liquid Filled Gauge 0-60 PSI	1
4	50-460B	Bushing 1/2 x 1/4 In Brass	1
5	11-071	Special Tee	1
6	52-116	Elbow Adapter 1/2 MPT x 3/4 In HB Poly	5
7	24-112SS	Hose Clamp #12 SS	6
8	50-412B	Street Elbow 1/2 In 45° Brass	1
9	M1200P	Nipple 1/2 In MPT Poly	1
10	TEE050	Tee FPT 1/2 In Poly	2
11	53-093	Adapter 1/2 MPT x 3/4 In HB Poly	1
12	11-0683	Battery Strap	1
13	53-094	Elbow Adapter 1/2 MPT x 1/2 In HB Poly	2
14	24-106SS	Hose Clamp #6 SS	4
15	SE12-P	Street Elbow 90° 1/2 MPT x 1/2 FPT	1
16	LV050MTV	Micro Valve 1/2 Female x 1/2 Male Poly	3
17	11-072	Frame Tubing	2
18	3350-0079A	Strainer Poly W/50 Mesh Screen	1
19	11-0686	Battery Mount	1
20	15-013	Poly Tank	1
21	53-884	Plug 1/2 In Poly	1
22	EL050-90	Elbow 90° FPT 1/2 x 1/2"	1
23	AA343M-3-1/2-PP	Ball Valve Assembly 3-Way Poly	1
24	41-513	Lock Nut 3/8 In SS	4
25	52-110	Adapter 1/2 FPT x 3/4" HB 90°	1
26	80-030	Tire and Wheel 14 In W/2 In Hub	3
27	42-104	Flat Washer 1/2 In	2
28	48-047	Shoulder Bolt Socket 1/2 x 2-1/4	2
29	11-073L	Left Mounting Bracket Tube to Axle	1
30	11-073R	Right Mounting Bracket Tube to Axle	1
31	53-091	Elbow Adapter 1/2 FPT x 1/2 HB Poly	2
32	51-416	Left Boom Tube 17-3/4 In SS	1
33	52-418	Pipe Saddle 1/2 In MPT Poly	3
34	11-474	Hinge Boom Pipe	2
35	47-103	U-Bolt 1/4 x 1-1/4 x 2-1/4 In Plated	2
36	51-415	Center Boom Tube 36 In SS	1
37	64-411	Single Nozzle Body W/Check Valve (Includes Item 55, 56 and 57).	8
38	51-417	Right Boom Tube 17-3/4 In SS	1
39	69-238	S-Hook 1-1/4 In	4
40	79-050	Battery	1
41	K1136-1/2	Spray Hose 1/2 In Blue, Per Ft	Specify
42	53-094	Adapter 1/2 MPT x 1/2 In HB Poly	2

## SDI Self-Contained Turf Walker Spray Boom

Item Number	Part Number	Description	Qty
44	CR050	Cross 1/2 In FPT Poly	1
45	15-095	Battery Box	1
46	11-069	Axle	1
47	11-0681	Battery and Pump Mount	1
48	34-119	Hex Bolt 1/2 x 5 In	1
49	52-588	Tube Plug 10-14 Gauge Sq. 1 In	2
50	42-104	Flat Washer 1/2 In	4
51	41-514	Lock Nut 1/2 In SS	1
52	69-910	Chain Steel Sash #40, Per Foot	Specify
53	K1136-3/4	Spray Hose 3/4 Blue 250 PSI, Per Foot	Specify
55	64-416	O-ring	8
56	64-414	Diaphragm	8
57	64-415/20	Check Valve 20 PSI	8
58	64-403	Strainer Screen Nylon	8
59	64-404	Rubber Washer	8
60	64-643	Tip TP8003VPPolymer	8
61	64-406	Black Cap	8
62	72-122	Switch Boot	1
63	70-035	Sight Gauge Decal	1
64	81-073	Speedometer Kit	1
65	56-021	Switch	1
66	31-101SS	Bolt 1/4 x 1-3/4 In SS	9
67	41-101SS	Nut 1/4 In SS	6
68	43-101SS	Lock Washer 1/4 In SS	6
69	32-504	Bolt 3/8 x 1-1/4 In SS	5
70	41-503	Nut 3/8 In SS	5
72	43-503	Lock Washer 3/8 In SS	5
77	41-513	Lock Nut 3/8 In SS	2
78	32-503	Bolt 3/8 x 1 In SS	2
79	69-288	Turn Buckle 4 In	1
80	31-007	Bolt 1/4 x 2" SS	2
81	31-008	Bolt 1/4 x 2-1/4" SS	2
82	41-511	Lock Nut 1/4" SS	4
83	42-501	Flat Washer 1/4" SS	4
		<i>Item not illustrated:</i>	
	70-036	Battery Charger and Pump Decal	1

7/1/11